



Dear Vendor:

The Box Elder Chamber of Commerce would like to extend an invitation for you to join us for our 2026 Peach Days Celebration. We appreciate your talents and unique gifts in our booth segment of our festival and hope you will share your talents with us. Enclosed you will find an application, a map of booth locations, Brigham City special event form, public safety check list, liability release, insurance requirement form and vendor's rules. **Please initial all pages and sign in appropriate spots. Please make copies of all forms for your own records and send in originals.**

Insurance requirements must be submitted within 30 days of submitting booth application.

You may send applications one of the following ways:

Mail – 75 South Main Street Brigham City, UT 84302

E-mail – shelley@boxelderchamber.com

It is your responsibility to call and verify the receipt of your application.

We are so excited for this year's festivities. We anticipate up to 50,000 people attending. As you may know Brigham City shuts down Main Street for two days to enjoy this festive celebration. Peach Days activities go throughout the week and booths will be in operation on Friday and Saturday, September 11 and 12, 10:00 a.m. – 10:00 p.m. in downtown Brigham City.

Our numbers continue to grow and booth space is limited, so please respond quickly. We have two areas for booths Main Street and the Community Center. The carnival sits in between the two and both are equally visited. Please specify first, second, and third choices for your booth location. Also, circle the exact location on the map and include the map with your application. Remember, this is a huge project and we cannot possibly please everyone. Your choice does not guarantee your booth assignment. We will send you a packet of information with your exact location.

Our goal each year is to improve the quality of booths, both in display and content. This year the booth sizes will be 12'x12' for food booths and 10'x10' for craft booths.

The price of craft booths begins at \$350. Larger booths are available for \$525 (look at map for locations).

Food booths are \$750.

Food trucks are \$1000.

We would love to have you join us for Peach Days and look forward to a fun and exciting event. If you have any questions, feel free to call me at 435-723-3931. Thank you for your time and consideration.

Sincerely,

Shelley Reynolds
Office Manager

Brigham City Peach Days 2026 Booth Application
Vendor Times: Fri. Sept. 11 and Sat. Sept. 12, 10 a.m. – 10 p.m.
Must submit insurance paperwork within 30 days
of submitting application.

Office Use Only
Date Received _____
Payment Method _____
Amount Received _____
Booth
Number _____

Booth map must accompany this application. Only merchandise listed on application will be allowed for sale.

Company Name: _____

Contact Person: _____ Work #: _____ Home #: _____

Address: _____ City: _____ State: _____ Zip: _____

E-Mail Address (**required**) : _____ (**Written in capital letters**)

For State Tax Commission we will need SSN, Individual Tax Number (ITIN), Sales Tax Account ID (STC), Sales Special Event ID, or Federal Employer ID Number (FEIN) Circle which number you are providing

Please be sure the information you return is accurate as this will be used for future mailing. Thanks!

Please list items for Sale. Please attach additional paper if needed. Also, you will only be allowed to sell items listed here. Food vendors please remember that we only allow one food vendor to sell a particular item in each location. You may sell only the menu items (be specific) that you have listed.

Peach Days does not permit to sell any cotton candy, hotdogs on a stick (corndogs), caramel and candy apples, guns of any kind, laser pointers, knives, martial arts stars, marshmallow shooters, potato guns, bows and arrows of any kind, no shocking toys, snaps, poppers, fireworks of any kind, swords-metal or plastic with pointed ends, (we are allowing the light up sabers, but they must have rounded blunt ends, or you will be asked to not sell them), or any toy that resembles these items or that could be in any way misconstrued as a weapon! Nothing vulgar, sexually explicit, suggestive, or not keeping with the family oriented and civic celebration atmosphere of Peach Days will be approved for display or sale.
Committee members have final say on these items. Vendors must obey all committee member requests.

Desired Booth Location: Main Street (6 N. Main St.) or Community Center (24 N. 300 W.) or Food Truck Area(Forest St)

	Choice #1 _____	Choice #2 _____	Choice #3 _____
	circle one	circle one	
Tent	<u>YES / NO</u>	Trailer: <u>YES / NO</u>	LENGTH OF TRAILER INCLUDING TONGUE: _____

Maps of each area are included. Please mark 1st, 2nd, & 3rd Choice above.

Maps are not to scale. Check the map carefully. *Some numbers have changed.* All vendor spots are outside and some spots might not be level due to grass, small hills, and cement. Be aware on the map of locations if they are on sidewalk or grass many booths might have both sidewalk and grass in the 10 x 10 area. Booth assignments are final.

_____ Initial Booth Space: Space is limited to 10'x10' for craft/retail booths and 12'x12' for food booths.

_____ Initial If you require more space you MUST pay for 2 spaces.

_____ Initial **THIS INCLUDES THE SPACE BEHIND YOUR BOOTH. IT IS NOT YOURS FOR CHAIRS/STOCK.**

_____ Initial **RETAIL BOOTHS:** If you utilize additional space behind the marked booth area you will be charged \$5.00 per square foot. If you do not pay you will be asked to move into the marked booth space.

_____ Initial **FOOD BOOTHS:** If you utilize additional space behind the marked booth area you will be charged \$7.00 per square foot. If you do not pay you will be asked to move into the marked booth space. This does include tongues on trailers.

_____ Initial Walkways behind booths need to be maintained for other vendors/officials.

_____ Initial Assigned locations are final.

_____Initial Retail/Craft Booths will be assigned on a first come first served basis. Be aware that Peach Days does not jury retail booth items, therefore competitors selling same products might be located in the same booth areas.

_____Initial **Vendors are limited to a total of 4 booth spaces.**

_____Initial Food Booths are NOT assigned on a first come first served basis and will be assigned at the discretion of the committee to ensure a variety of food choices are given to the attendees of Peach Days.

_____Initial Once all booths are filled, we do not accept more applications.

_____Initial There are a limited number of booths at the event and we do sell out each year.

_____Initial **The decision on which booth you receive is the choice of the committee. All decisions are final.**

_____Initial **The committee does reserve the right to deny a booth to any company or individual.**

Booth Cost:

Non-Food 10x10	\$350	Food	\$750
Non-Food 10x15	\$525	Food Truck	\$1000

_____initial Booth Fee Includes: Ground Space, Brigham City Special Event Permit, and 1 Electrical Outlet
Booth Fee does NOT Include: tables, canopies, or chairs

_____initial **Ice: Ice will not be provided.**

_____Initial **Tie Downs: There will be NO STAKES IN THE GROUND at Peach Days. Please plan on securing your canopy with sandbags or water jugs (must be at least 40lbs on each canopy leg). **If a vendor does use stakes to secure the canopy, which is in violation of Peach Days policies, it will be noted during the Friday inspection done by city staff and Peach Days volunteers. After the event, if sprinkler lines have been damaged, the vendor will be responsible for payment of repair of sprinkler lines.**

_____initial **Payment:**

An invoice will be sent upon acceptance.

It will come via e-mail. You will then have 15 days to pay invoice to reserve your booth.

_____Initial **Special note:** Peach Days is a family and civic celebration of the Brigham City heritage and culture. Nothing vulgar, sexually explicit, suggestive, or not keeping with the family oriented and civic celebration atmosphere of Peach Days will be approved for display or sale. All vendors must maintain a clean booth area. Peach Days prohibits the sale and/or consumption of alcoholic beverages in the vending areas. Brigham City ordinance prohibits smoking and vaping in city parks, recreational areas and within 50' of mass gatherings including Peach Days.

_____Initial **NO REFUNDS AFTER JULY 1, 2026**

If you Fail to comply with Peach Day's rules found in these documents, you will be asked to leave with no refund!!!!

Return Application to: E-mail: shellee@boxelderchamber.com
Any questions call: 435-723-3931

Mail: Box Elder Chamber of Commerce
75 South Main Street
Brigham City, UT 84302

It is your responsibility to call and verify the receipt of your application.

_____Initial 1. Insurance Requirements: If you are selected as a vendor, Brigham City's Peach Days requires each vendor to provide a Certificate of Liability Insurance (\$1,000,000.00 per occurrence/\$3,000,000.00 aggregate), with Brigham City Corporation/Box Elder Chamber of Commerce as an additional insured valid September 11-12, 2026. See policy application enclosed if you do not have a general liability policy.

_____Initial 2. You may conduct business **only** from your assigned space. You may not solicit, sell or collect names or in any other way conduct business outside of your booth space.

_____Initial 3. You must check with an assigned representative of Peach Days to receive your business license. There are two check-in locations, one for Main Street vendors and food court at the Chamber office (75 South Main Street), the second for Community Center vendors and food court at the Community Center (24 North 300 West).

_____Initial 4. Loading/Unloading areas are **TOW ZONES**. If you park there longer than 60 minutes – **you will be towed**. With 250 booths, space is limited so unload within 1 hour. Do not drive on grass to unload items, plan on carrying items from parking areas. You will receive a parking pass to load/unload only. You will then need to move your vehicle. Your parking permit **must be displayed on your windshield at all times**; failure to comply could result in towing at your own expense. Parking is at least 2 blocks away, please plan on walking. Community Center Food Vendors, you will be unable to park on Forest Street on Saturday because the whole road will be closed for other Peach Days activities.

_____Initial 5. Use of Peach Days: The use of the words “Peach Days” or “Brigham City Peach Days” requires written permission. These are registered with the state of Utah.

_____Initial 6. If you have a complaint or issue with another vendor, please contact a Peach Days official to discuss it. The Peach Days official will then handle it and speak to the vendor if needed.

_____Initial 7. You must plan for entryways and exits from your own booths. Please do not plan on using neighboring booths as your entry/exit.

_____Initial 8. Only one 110-volt outlet is included with your booth, you will need to bring extension cords and surge protectors. For food booths, if you require an additional 110 or a 220 outlet you will need to verify with the electrician on the cost (minimum cost for an additional outlet will be \$40, additional amps will be more. A late fee of \$80 will be charged for each additional outlet requested the week before or day of event. **Electricity will begin at 9:00 a.m. on Friday and will be turned off at 11:00 p.m. on Saturday (food vendors please be aware of this)**. Please plan accordingly.

_____Initial 9. Security: You are responsible for the security of your own property and equipment. Vendors may leave heavy equipment in booths overnight, but Brigham City Corporation and the Box Elder Chamber of Commerce are not responsible for loss, damage, or theft of any property at any time.

_____Initial 10. Vendors must remove their own trash and debris each day. During the event please be aware that 90-gallon garbage cans located in the vending areas are for the use of the Peach Days spectators. Larger 300-gallon garbage cans will be located in the vending areas for your use. Please be aware that breaking down your boxes will help minimize overfilling.

_____Initial 11. Set Up/Take Down: ALL vendors must plan on setting up Thursday night at assigned times. **VENDORS MAY NOT SET UP ANY PART OF THEIR BOOTH PRIOR TO 5:00 P.M. ON THURSDAY. CITY AND COUNTY OFFICES ARE OPEN FOR BUSINESS AND CANNOT HAVE VENDORS SETTING UP WHILE THEY ARE OPEN.** ALL vendors must also tear down on Saturday night.

_____Initial 12. All vendors except those with a Utah State sales tax exemption number (IC followed by four digits) must collect and pay sales tax to the Utah State Tax Commission. All vendors will now be required to file sales tax on earnings at Peach Days with a special event tax form. The Utah State Tax commission will either email or mail to the address you provided on your application. All tax transactions are between you and the State of Utah. Vendors who have questions should contact the Utah State Tax Commission directly. If you have a tax compliance issues with the State of Utah, they can stop you from participating in the Peach Days event. The auditors at the State Tax Commission DO have a list of vendors and will contact you if you to fail to report and pay sales tax.

_____Initial 13. Disobeying these rules may affect vendors being asked to participate in future events. If a Peach Days official determines that you are disobeying these rules and/or that you are not to adhering to their instructions your business will not be allowed to participate at Peach Days in the future.

I agree to all rules presented on these pages. I will obey these rules as well as any other instructions given to me by Peach Days officials.

Signature: _____

Date: _____

Liability Release Peach Days

Company Name _____

Contact Name _____ Phone _____

Box Elder Chamber of Commerce and Brigham City Corporation do not discriminate on the basis of race, color, national origin, sex, religion, age, or disability. If you need assistance due to a disability, please notify the Box Elder Chamber of Commerce at (435)723-3931.

Please fill out the following statement and send it with your enclosed request form.

I, _____, have read and understand the above rules and regulations and understand that if I do not comply, I will be immediately removed from the Peach Days Event without a refund.

Signed _____ Date _____

Liability Release:

I, the undersigned, agree to indemnify and hold harmless the Box Elder Chamber of Commerce and Brigham City Corporation, their agents, employees, or volunteers from any and all liability for bodily injury, or property damage, or loss sustained by me, my agents, customers, employees, and/or any other individuals passing by my booth location as a result of or arising out of our activities conducted or engaged in pursuant to this agreement. I further agree to abide by all the rules and regulations pertaining to these events set forth in these documents and any other written or verbal directions from the directors of this event.

I, the undersigned also agree to indemnify and release all parties contemplated herein for the cancellation of Peach Days, due to an act of a foreign enemy, riot, civil commotion or disorder, mob violence, act of civil disobedience, act of terrorism, **plague, epidemic, pandemic, outbreaks of infectious disease or any other public health crisis, including quarantine or other employee restrictions**, act of authority whether lawful or unlawful, compliance with any law or governmental order, rule, regulation or direction, curfew restriction, act of God or natural disaster such as but not limited to violent storm, cyclone, typhoon, hurricane, tornado, blizzard, earthquake, volcanic activity, landslide, tidal wave, tsunami, flood, damage or destruction by lightning, drought; explosion, fire, or any other unforeseen event outside the control of those parties contemplated herein ("Force Majeure Event"). In the case of a "Force Majeure Event" refunds of total booth fees and any electrical payments will be made back to party that paid the vendor fees within 60 days.

Signed _____

Office Use Only

Vendor Name _____

Booth Number _____

BOOTH ELECTRICAL NEEDS

Peach Days will provide one 110 electrical outlet to booths. Vendors must provide all cables and extension cords.

Only one 110-volt outlet is included with your booth, come with extension cords and surge protectors. None will be provided.

Food Booths: If you require an additional 110 or a 220 outlet you will need to verify with the electrician on the cost (minimum cost for an additional outlet will be \$40, additional amps will be more. Please list voltage, amperage and plug for each circuit. There are limitations to what can be provided for each vendor location. So it is your responsibility to get this information to the electrician prior to the event. A late fee of \$80 will be charged for each additional outlet requested the week before or day of event.

Please send a picture of any special plugs you are using.

All Vendors - Electricity will begin at 9:00 a.m. on Friday and will be turned off at 11:00 p.m. on Saturday (food vendors please be aware of this). Please plan accordingly.

Please check one of the following:

- I need 1 (110-volt) outlet (this is not additional cost and is included with your booth)
- Other*

Food Vendors: (Please list voltage, amperage, and plug for each additional line/appliance). The electrical vendor contracted with Peach Days needs as much detail prior to the event to ensure that your needs are met. If you do not make arrangements for electrical needs prior to the event, you will work directly with contracted electrical vendor to meet your needs, additional fees may apply that would be payable to the electrical vendor.

BRIGHAM CITY PUBLIC SAFETY CHECKLIST FOR PEACH DAYS

1. One fire extinguisher, 2A10BC (5 pound), if preparing or cooking food.
2. No propane stoves, lanterns, or heaters located inside of tents of temporary structures.
3. All heat sources (lights) must have sufficient clearance from all combustibles (canopy tents).
4. Propane bottles must meet current National Fire Protection Association (NFPA 58) requirements.
5. Propane bottles must be secured to a fixed object or have a stand to avoid being knocked over.
6. All exits must be free of objects. NO stacking in the exits.
7. No gasoline powered equipment maybe operated inside of tents or temporary structures.
8. All helium bottles must be secured to avoid being knocked over.
9. Copy of current temporary food event permit from the Bear River Health Department if providing food must be displayed in booth.
10. Vendor employees are the only individuals allowed in cooking area.
11. Tents/canopies must be secured by sandbags or water jugs to avoid being blown over, must be at least 40lbs on each canopy leg.
12. All extension cords must be secured and not create a trip hazard. Examples are duct tape or mechanical bridges.
- 13. All fire lanes must be maintained open at all times. You MAY NOT park in the fire lanes to load and unload items. If you park in the fire lane, you will be asked to leave and may not be invited back in coming years. This is for your safety and the safety of others at Peach Days. Each year we have multiple vendors that break this rule. If vendors park in the fire lane for any amount of time it can and will affect your participation in future Peach Days celebrations. Our fire department officials will be monitoring this throughout the event.**
14. Hot charcoal must be placed in nonflammable containers and must be secured from public access. Hot charcoal must be removed from the site following the close of business and shall not be placed in the city's garbage cans.
15. All permits (Brigham City and Bear River Health Department) must be clearly displayed.

NOTE: Vendors found in violation of the Public Safety Check List requirements will be precluded from future events and all local, state, and federal laws will be administered accordingly.

Date _____

Signature _____



Business Licensing 435-734-6600

Business License/Permit No:	_____
License/Permit Fee	\$ _____

BRIGHAM CITY

PEACH DAYS VENDOR PERMIT APPLICATION

This form becomes a permit when approved and signed by Brigham City.

DATES OF EVENT: Friday & Saturday, September 11-12, 2026 **PERMIT EXPIRES:** September 12, 2026

LOCATION OF SALE: Approved Peach Days location: Downtown Brigham City, Bill of Rights Plaza, Watkins and Pioneer Parks, West Forest between Main Street and 300 West, and Community Center

CITY APPROVAL: _____ **Date:** _____

Applicant Must Complete All Fields

Business Name _____ Owners Name _____

Describe Business

(Fold here for display – Permit must be posted in a conspicuous place –Permit is non-transferrable)

Daytime Phone Number _____ Cell Phone Number _____

Mailing Address _____ Email Address _____

City _____ State _____ Zip _____ TEMP SALES TAX # _____

Issued by Chamber of Commerce from Tax Commission

Federal ID (EIN) **DO NOT ENTER YOUR SSN** _____ DATE OF BIRTH _____

SIGNATURE OF AUTHORIZED AGENT/OWNER _____ **Date** _____

CITY USE ONLY

Health Dept Primary Permit _____	Expires: _____	Liability Insurance _____
Health Dept Secondary Permit _____	Expires: _____	Insurance Expires: _____
Annual Fire Inspection _____	Expires: _____	Other: _____

Peach Days Insurance Fulfillment Page
Peach Days 2026
September 11 - 12, 2026

All vendors at Brigham City's Peach Days must provide a certificate of insurance. If your business or as a vendor, you have your own general liability insurance you must send the Box Elder Chamber a Certificate of Liability Insurance (\$1,000,000.00 per occurrence/\$3,000,000.00 aggregate), with Brigham City Corporation/Box Elder Chamber of Commerce as an additional insured valid September 11-12, 2026.

Vendors who **DO NOT** have a General Liability policy and CANNOT provide a Certificate of Liability may purchase one. Application is on the Peach Days Insurance fulfillment page in this application. Cost for this policy this year is \$69.10. (*Premium is fully earned upon inception and not refundable in the event of cancellation.*) There is a 3.5% fee if using a credit card and no fee if using a checking account. This cost is payable directly to the broker, Cortney Gregory & Associates, Inc., located at 102 East Forest Street, Brigham City, UT 84302, you may also call them at 435-465-3891 or email requests and information below to cortneygregoryagency@amfam.com

PLEASE COMPLETE ALL QUESTIONS (2 pages)

Full Legal Name or Business Name: _____

Type or Operation (mark with an 'X'): ___ Corporation, ___ Individual/Sole Proprietor, ___ Partnership, ___ LLC,
_____ Other

Are you operating under a Doing Business As (DBA) Name? _____

If so, please list the name of the DBA. _____

Contact Information

First Name _____ Last Name _____

Mailing Address: _____

City: _____ State: _____ Zip Code: _____

Phone Number: _____ Email Address: _____

Payment Options:

Checks: Make Checks Payable to Cortney Gregory & Associates, Inc.

Credit Cards Accepted (3% fee applies): Visa, Mastercard, or AMEX

Description of your exhibits/goods:

Vendor Type: (please select one)

- | | |
|--|---|
| <input type="checkbox"/> Antique & Collectibles Vendor | <input type="checkbox"/> Apparel & Accessories |
| <input type="checkbox"/> Arts & Crafts Vendors | <input type="checkbox"/> Celebrity, Mascot, or Character Appearances/Photo Booths |
| <input type="checkbox"/> Cookware | <input type="checkbox"/> Face Painting |
| <input type="checkbox"/> Food & Drink | <input type="checkbox"/> Game Trailers or Booths |
| <input type="checkbox"/> Gift Wrap Booths | <input type="checkbox"/> Micro-Reality Race Tracks |
| <input type="checkbox"/> Photo Booth | <input type="checkbox"/> Produce & Floral Vendors |
| <input type="checkbox"/> Product Demos – Static, | <input type="checkbox"/> Product or Service Display Exhibits |
| <input type="checkbox"/> Retail Carts | <input type="checkbox"/> Souvenir Sales |
| <input type="checkbox"/> Sports & Camping Equipment | <input type="checkbox"/> Vehicles, Equipment, or Hardware Sales on Display – Static |
| <input type="checkbox"/> Other Vendor Type _____ | |

1-Will your exhibit or goods involve any use of Fire other than cooking, Fireworks or Firearm Ammunition? _____

2-Has your past liability coverage been canceled in any way in the last three years? _____

3-Is your current insurer non-renewing coverage? _____

4-Have any liability claims been paid by your insurer during the last three years? _____

5-Will your exhibit include mechanical or inflatable amusement devices? _____

6-Are any of the event operations to be insured located outside the United States? _____

6- Have you or your company ever been involved in any legal dispute relating to the operations or products of your company? _____

7- Do you operate any of the following: *Body piercing or tattooing, Catering Companies, Christmas tree retail lots, Corn or Hay maze, Disc-Jockeys for events over 200 attendees, DJ Companies with more than 1 Employee, E-commerce selling, Entertainment and Film Industry Vendors, Fire Dancing, Fire Eating, Food Trucks, Haunted attractions, Heavy Machinery, Hot wax impressions, Live Edge Weapon Performers, Live animals, Live Bands with more than 1 individual, Marijuana and other cannabis products and/or paraphernalia, Massage, Medical testing, Motor sports activities, Nutritional/health supplements, On-site installation/service/repair of products, On-site equipment rental, Oxygen/aromatherapy, Storefront operations, Timeshare sales, Tobacco products, Vehicles in motion, Watercraft exhibits on water, Weapon Throwing, Weapon sales, Weight-loss plans or products, Wholesale business?* _____

8 – Is the applicant a non-US resident or non-US-based business? _____

Email insurance application to cortneygregorvagency@amfam.com

Once payment has been applied and application has been submitted, you will receive a confirmation email along with the certificate of insurance. The Box Elder Chamber of Commerce will also automatically receive confirmation and a copy of the certificate of insurance.

Main Street Location

Brigham City Hall

Parking Lot

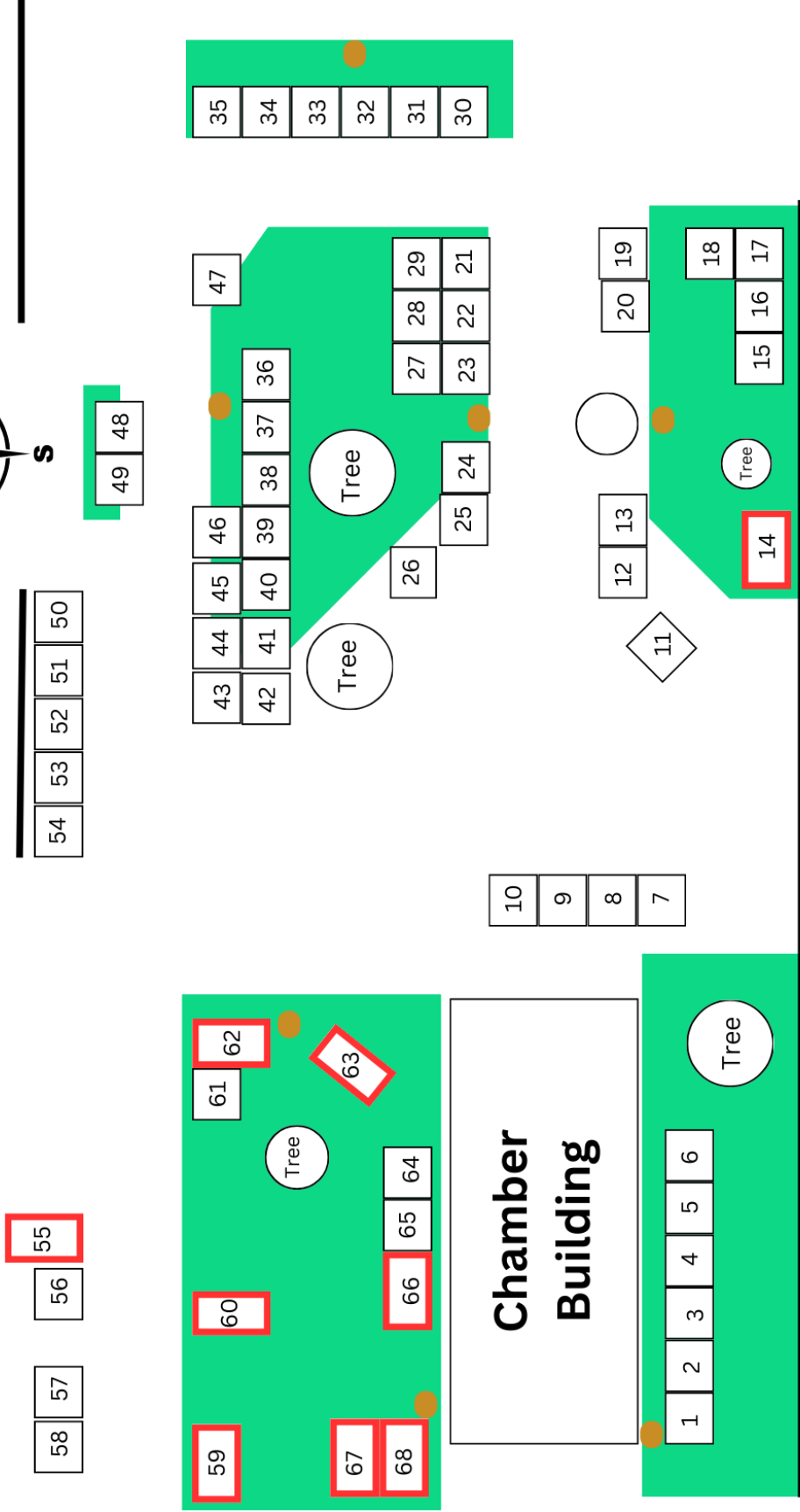
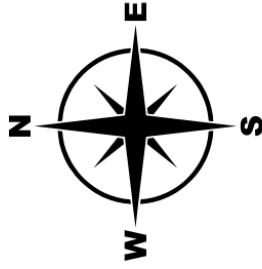

Map is not to scale All vendor spots are outside and some spots might not be level due to grass, small hills, and cement. Be aware on the map locations on sidewalk and grass in the 10x10 area. Booth assignments are final.

● Electrical Service

□ 10x10 Booth \$350

□ 10x15 Booth \$525

Main Street Food Court

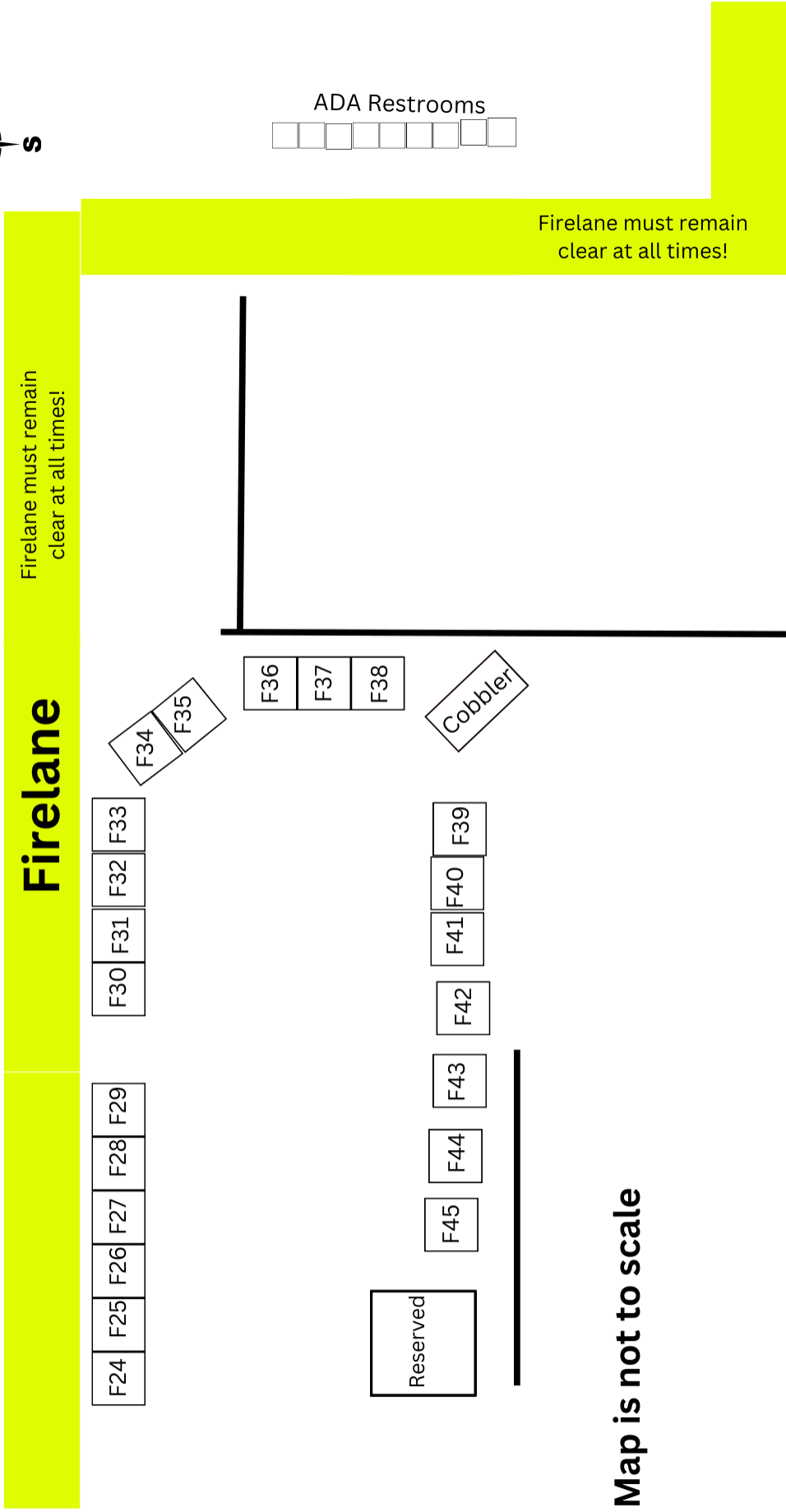
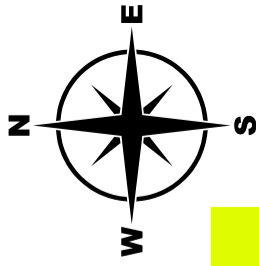

Map is not to scale

12X12 Food Booth \$750

Community Center Locations

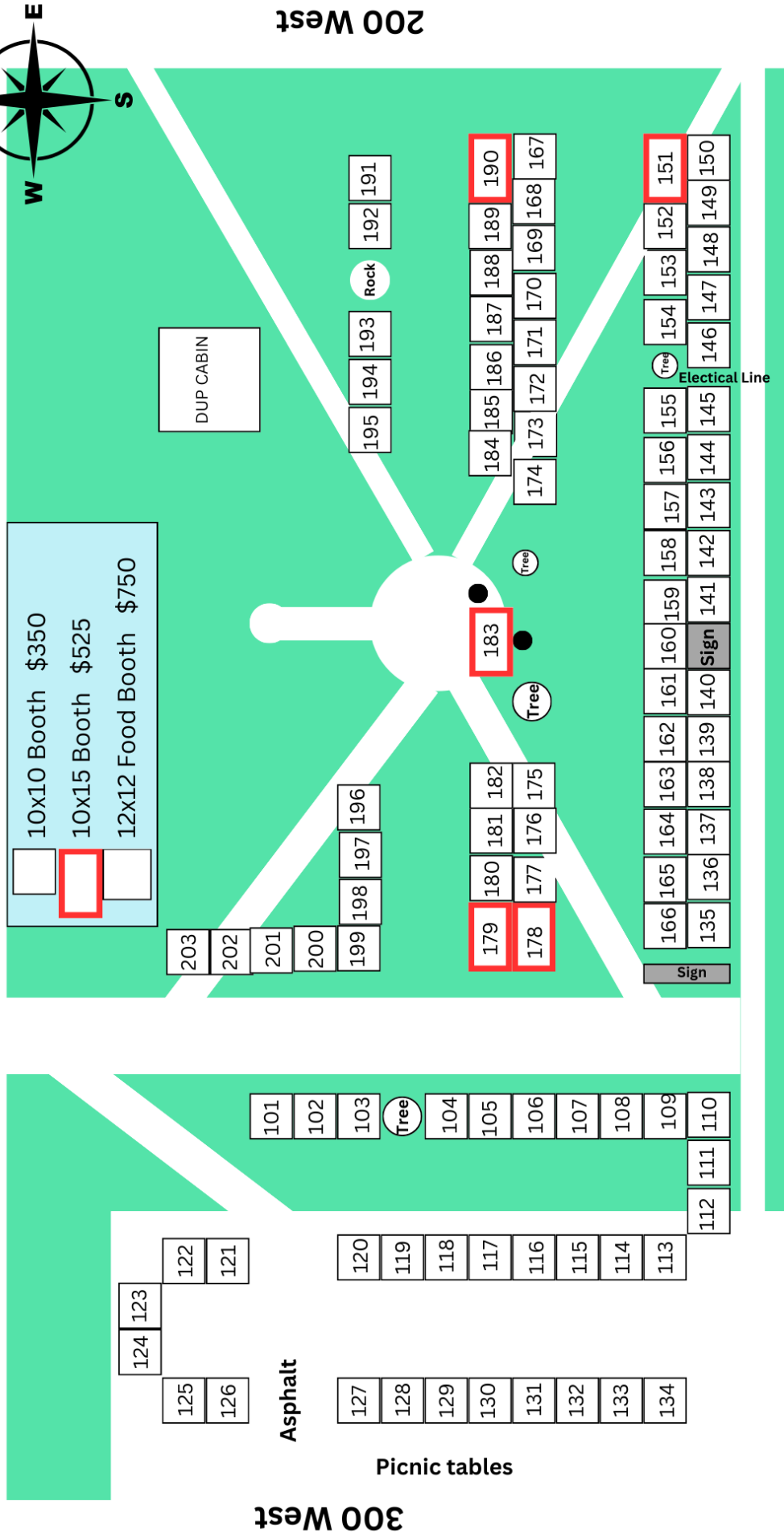
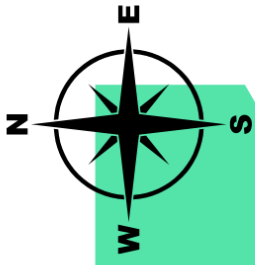

- F1
- F2
- F3
- F4
- F5
- F6
- F7
- F8
- F9
- F10
- F11
- F12
- F13
- F14
- F15
- F16
- F17
- F18
- F19
- F20
- F21
- F22
- F23

Map is not to scale All vendor spots are outside and some spots might not be level due to grass, small hills, and cement. Be aware on the map locations on sidewalk and grass in the 10x10 area. Booth assignments are final.

Food Truck Area

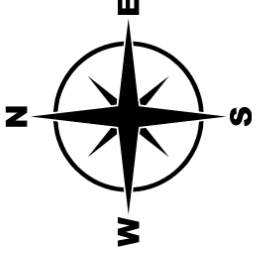

200 West

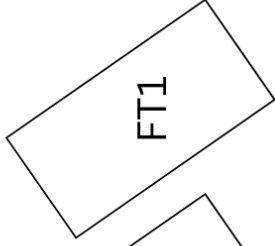
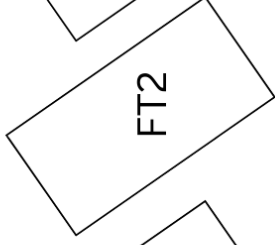
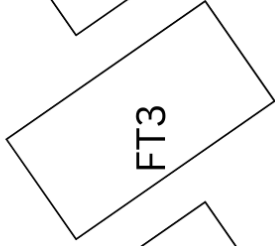
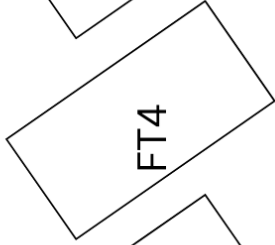
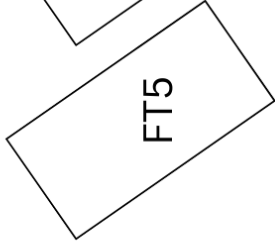

P & G
Diaper
Area

Rest
Area

100 West

Forest Street

Food Truck \$10000